



DEVELOPMENT OF INTEGRATED DIVISIONAL OFFICE COMPLEX OF VARANASI DEVELOPMENT AUTHORITY



Architecture Master Planning Interior Design Conservation Landscaping Project Management

www.muralage.com





LOCATION INTEGRATED DIVISIONAL OFFICE COMPLEX

➤ LOCATION : COMMISSIONER'S COMPOUND, KACHAHARI, VARANASI

➤ PLOT AREA FOR OFFICE BUILDING : 10522.0 SQ.M OR 2.6 Acres

➤ FAR: 2.5

➤ Ground Coverage: 40%

INTEGRATED DIVISIONAL OFFICE COMPLEX

- OFFICES (NON-SALEABLE)
- MEETING HALL/ CONFERENCE ROOMS
- CAFETERIAS/ FOOD COURT
- SUPPORTING INFRASTRUCTURE

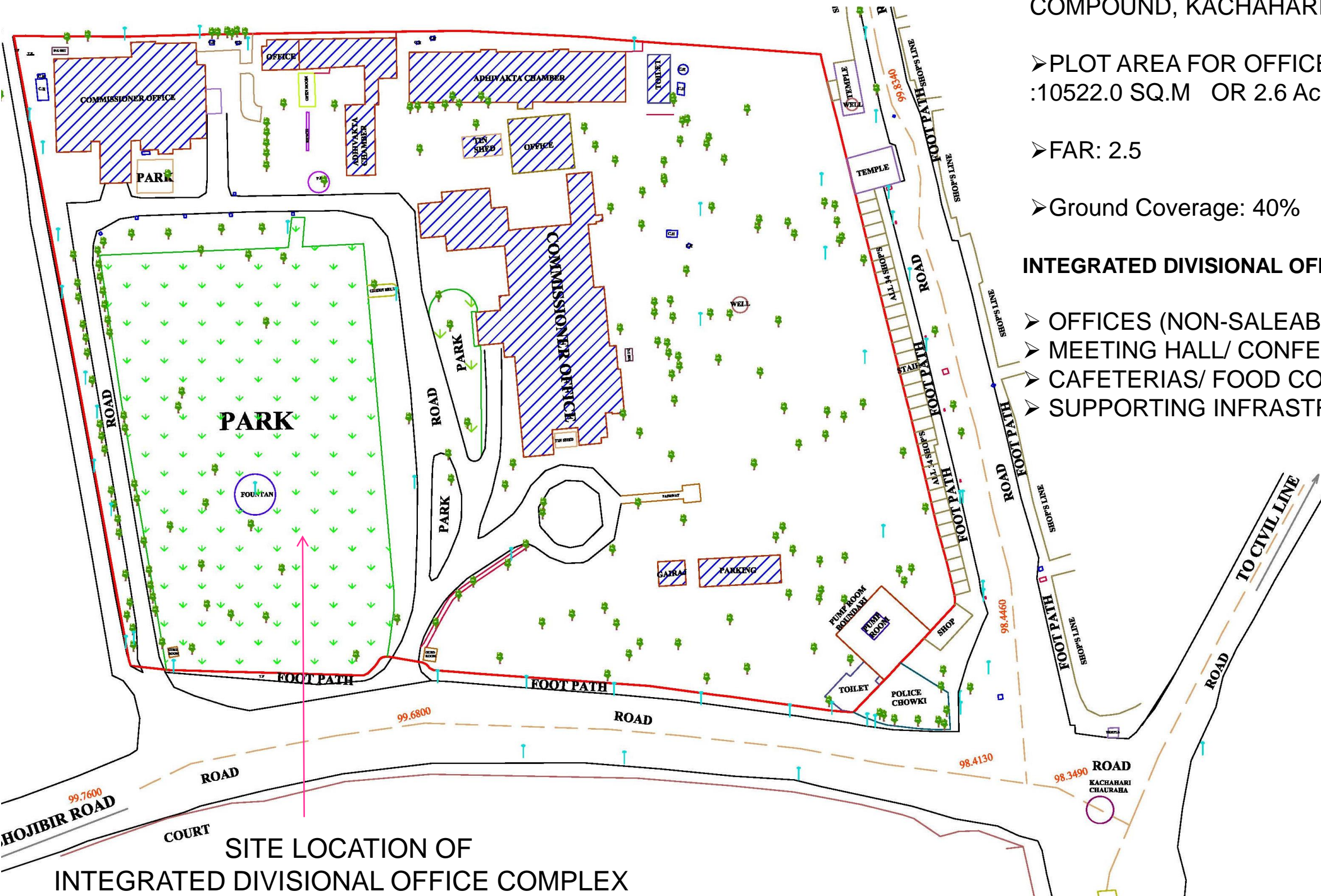

SITE LOCATION OF INTEGRATED DIVISIONAL OFFICE COMPLEX



SITE PLAN

EXISTING
COMMISSIONER'S
CHAMBER (G)

PROPOSED
COURT BLOCK
(G+4)

PROPOSED OFFICE
COMPLEX BLOCK-B
(-2B+G+10)

CAFETERIAS/ FOOD COURT ,
CONFERENCE ROOMS & UTILITIES
(-2B+G+4)

PROPOSED OFFICE
COMPLEX BLOCK-A
(-2B+G+10)

EXTENSION OF
ADHIVAKTA CHAMBER
(G+1) add
(SECOND FLOOR)

STP 130 LKD

ESS 3000 KVA

EXISTING
COURT BLOCK
(to be demolished)
(G)



GRID SIZE : 25 M x 25 M

Copyright @ muralage 2021



PROJECT SUMMARY

S.NO.	PARTICULAR	DETAILS
1	PLOT AREA	6.68 ACRE (2.70 HA)
2	SITE AREA	2.6 ACRE (1.05 HA)
3	TOTAL OFFICE TAKEN	59
4	NO. OF FLOORS (OFFICE TOWERS)	G+10
5	NO. OF FLOORS (SUPPORTING PLAZA)	G+4
6	NO. OF BASEMENT	-2 B
7	NO. OF FLOOR (COURT BUILDING)	G+4
8	NO. OF COURT	7+1 =8 NOS
9	BUILDING HEIGHT	42.0 M
10	TOTAL BUILT-UP AREA (OFFICE BLOCK)	27005 SQM
11	BUILT-UP AREA (SUPPORTING PLAZA)	1495 SQM
12	BUILT-UP AREA (BASEMENT)	9700 SQM
13	BUILT-UP AREA (COURT BUILDING)	3038.35 SQM
14	PARKING CAPACITY	600 CARS & 755 Two Wheeler
15	PROPOSED GROUND COVERAGE	11.46% (P) 6.79%(E) 18.25 (T)
16	PROPOSED FAR	1.37
17	COST OF BASEMENT	50.65 CRORE
18	TOTAL COST OF PROJECT	289.98 CRORE
19	STP CAPACITY	130 KLD
20	WATER TANK CAPACITY	378 KLD
21	FIREFIGHT CAPACITY	430 KLD
22	ELECTRICAL LOAD	2770.6 KVA
23	DG LOAD	500 KVA / 2 NOS
24	TRANSFORMER	1500 KVA / 2 NOS
25	HVAC	900 TON
26	TOTAL OFFICE CAPACITY	1200 PERSONS
27	VISITOR	1600 PERSONS

BUILDING FRONT VIEW



BUILDING REAR VIEW



SUPPORTING PLAZA VIEW





FACADE DESIGN ELEMENTS INSPIRATION

Shri Kashi Vishwanath Temple



Office Building



- Arch depicting Kashi Vishwanath Temple Shikhar
- Descending Arches
- Dholpur stone finishes
- Dome inspired from Central Dome of Shri Kashi Vishwanath Temple
- Pyramidal dome inspired from Nagara style of Architecture.

- They are mountain like the spire of a free-standing temple.
- Shikhara is found in north Indian Temples and Vimana is found in South Indian temples.
- Shikhara has a curving shape while vimana has a pyramidal-like structure.
- In Elevation it exhibits a tower(Shikhara) gradually inclining towards in a convex curve.

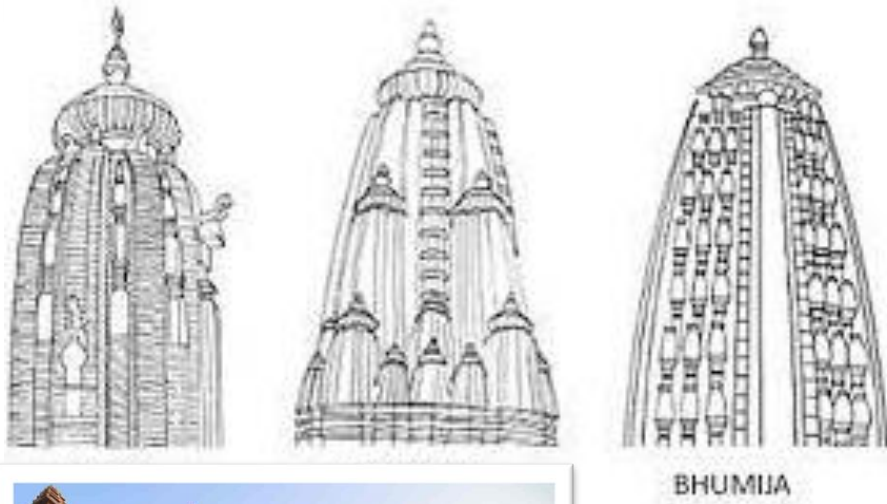

BHUMIYA

- Wide Steps being incorporated in the central part of the supporting plaza Area.
- Inspiration from the Ghats of Varanasi.

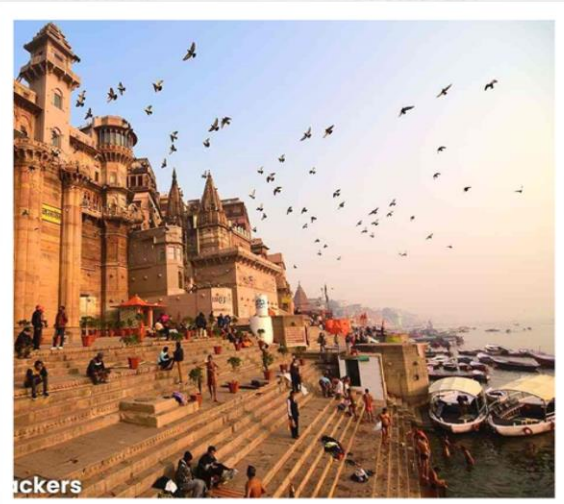

Copyright @ muralage 2021

FACADE MATERIAL SPECIFICATION

10 Domes – RCC with stone finish.



• Jaali – Stone Finish



• Central Arch - RCC



• Supporting Plaza - Terracotta Tiles



• Stone finish GRC Jali • Small Arches – RCC with tree cover

LIGHTING NIGHT VIEW

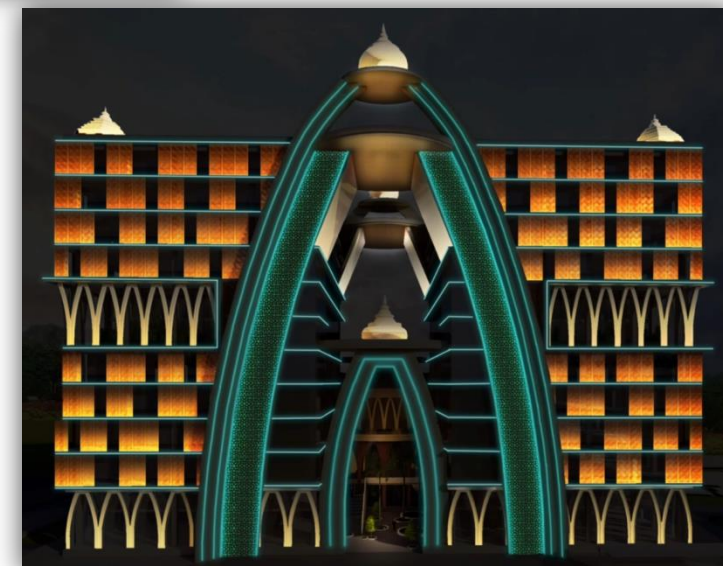
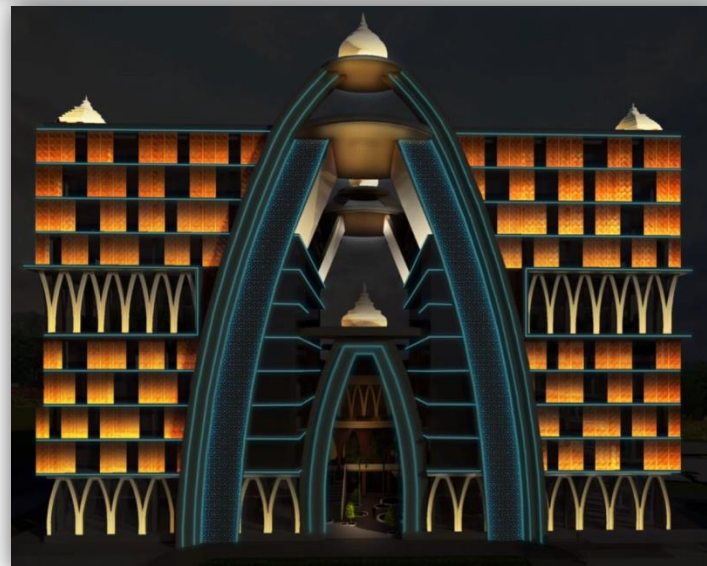
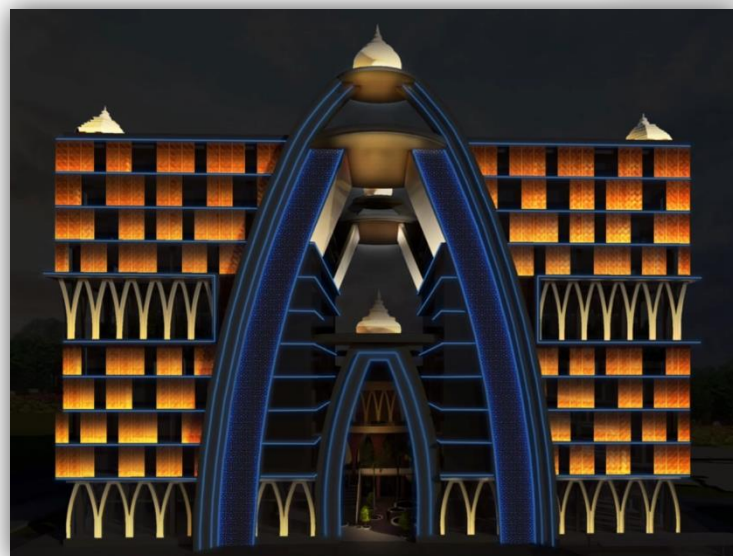
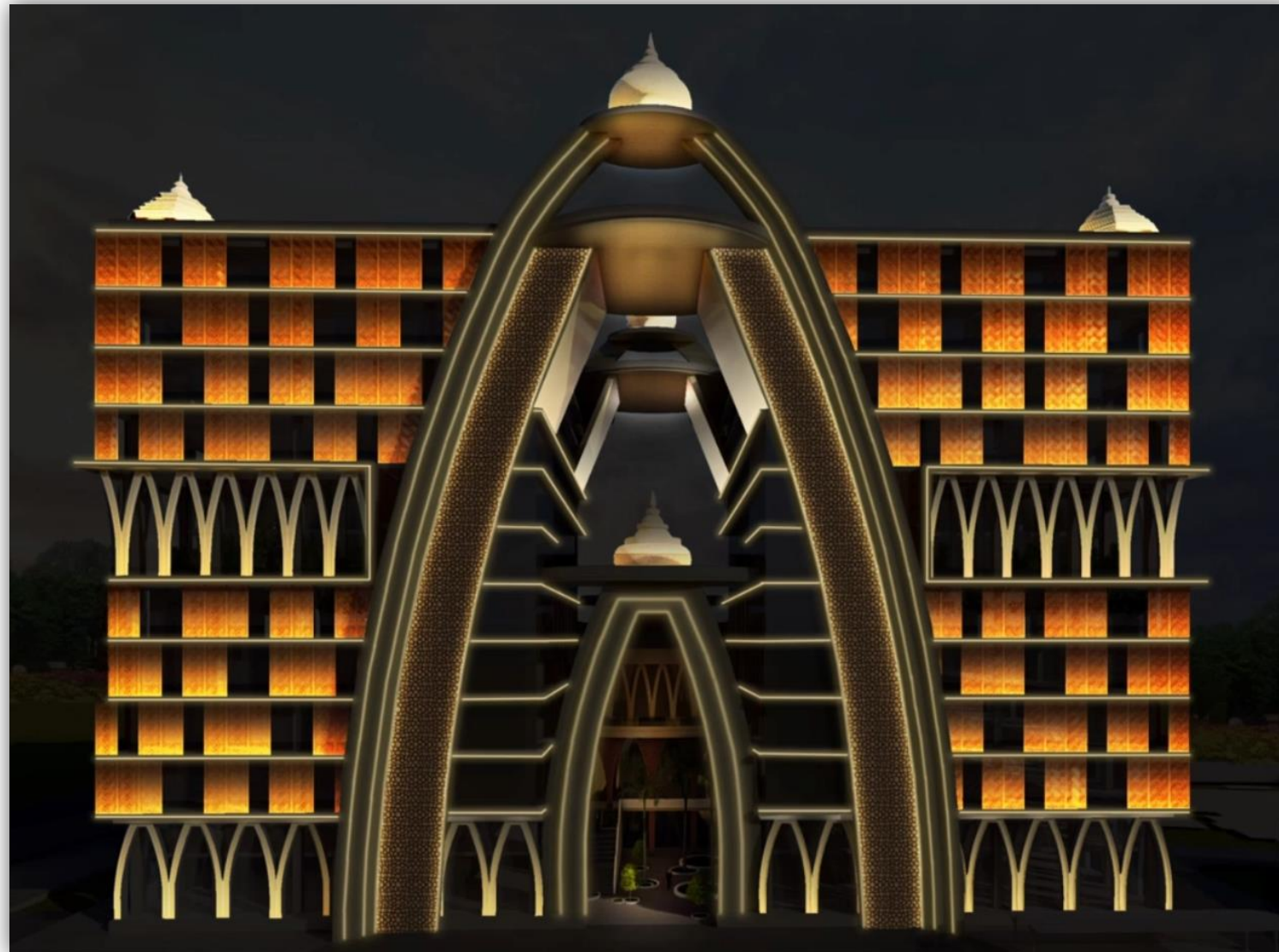

Office Building Reception interior View



Office Building Entrance Lobby interior View



Office Building Conference & Office Building Corridor View interior View

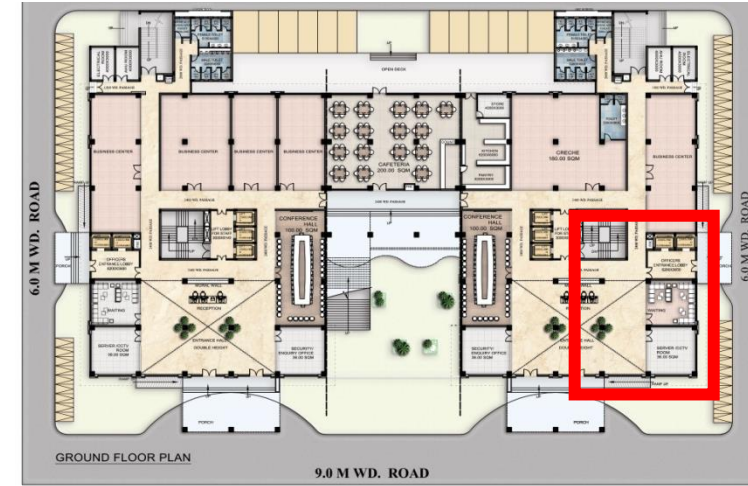
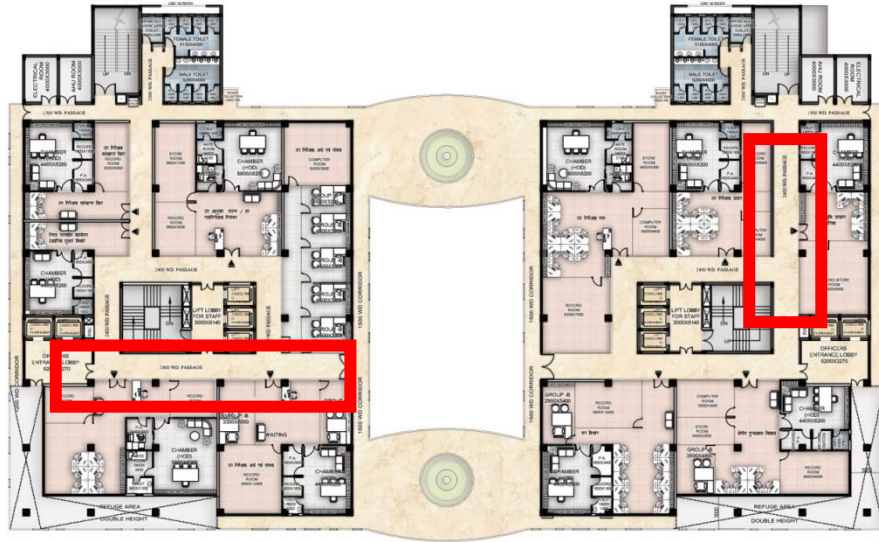

Office Building Working area interior View





Office Building Ground Floor Plans



GROUND FLOOR PLAN

9.0 M WD. ROAD





m u r a l a g e

architecture

master planning

interior design

conservation

landscaping

project management



THANK YOU